

GRIPPLE®

.....

HVAC Unit Hanging Kit

Ideal for suspension



What Is UniGrip?

Unigrip is the next generation of wire rope suspension products. Unigrip is a direct replacement for threaded rod, in that it features an attachment to a substrate and an attachment to the service.

Key Applications include the suspension of:

- Pipework
- Rectangular Ductwork
- Plenum Boxes
- Cable Containment
- Air Conditioning units
- Radiant Panels
- Heating/Cooling/Ventilation Units
- Chilled Beams
- Heavy Duty Lightning/Signage
- Busbar
- Modules
- Multi tiered installations

Applications

Commercial:

- FCU
- Cassette
- Plenum
- VAV's

Domestic:

- Ducted Air conditioning unit and drip tray



Order Guide

Kits come in packs of four (4):

- Drop length i.e. 1m,2m and etc.
- Fixings i.e. concrete (Rag) or Purlin/Timber (Lg)

Domestic kits can come with an additional duct trapeze for the drip tray attachment

Example Order:

Commercial Example:

10 FCU's with a concrete fixing at 2m drop length:

10 kits	= 40 Hangars
Part Code	= UG2-W-RAG-2M

Domestic Example:

5 kits	= 20 Hangars
Unit has drip tray	= DT2
Part Code	= UG2-W-LG-3M-DT2

*All domestic units are at 3 metres.



Application Examples



Installation with threaded rod
(traditional method)



Installation of FCU with drip tray

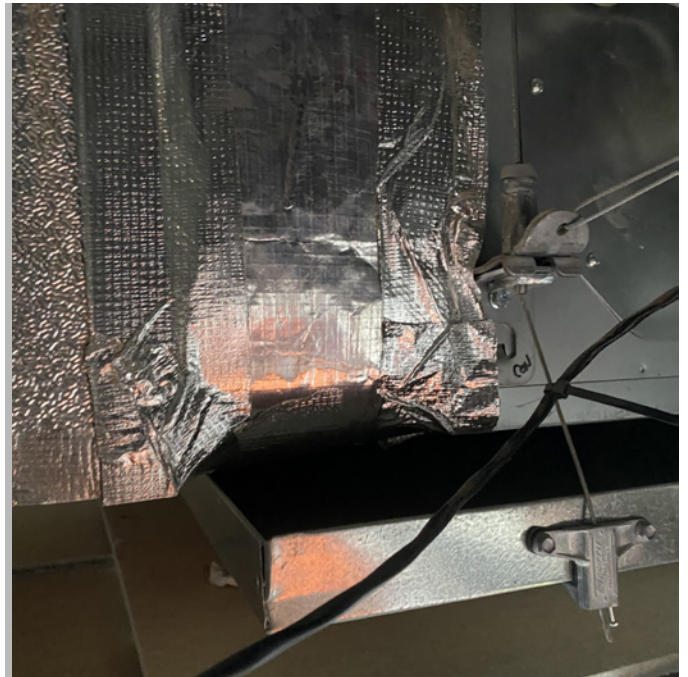

Installation of FCU



Installation of Cassette



The next generation of wire rope suspension products designed for the fast suspension of cable containment, pipework, ductwork, HVAC systems and modules including multi-tier installations.

FEATURES / BENEFITS

- **Quick** – up to 6 times faster than traditional suspension systems
- **Safe** – can be pre-installed to channel using pre-fitted washer/nut or using retention clip, reducing time working at height
- **Easy** – integral ergonomically designed release button allows for simple adjustment
- **Secure** – button acts as a locking screw and indicator clearly highlights the wire is locked in position for ultimate security
- **Versatile** – variety of foot attachments available to suit applications
- **Strong** – highest load rating capability to date; up to 250 kg with 5:1 SWL

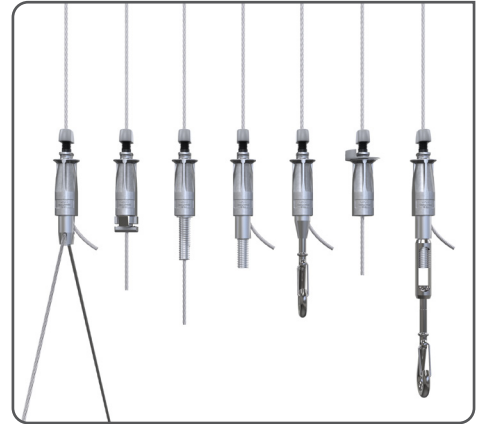

INSTALLATION & ADJUSTMENT

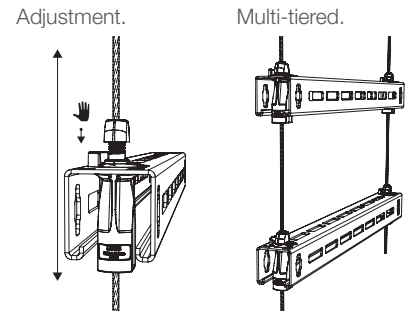
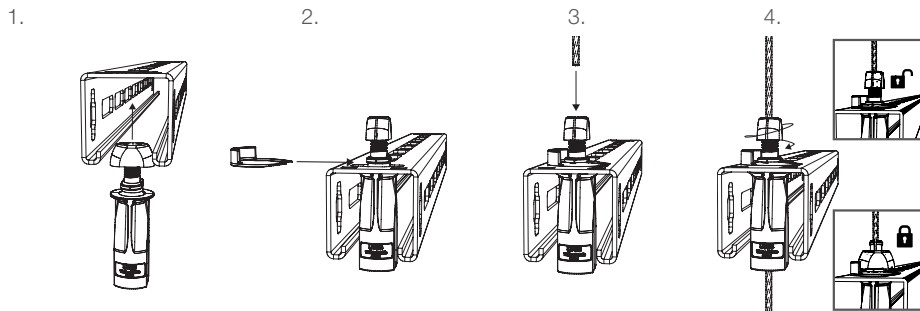

Maximum off axis suspension = 15° (unless otherwise specified by Gripple Technical Services)
 NOTE: UniGrip No.4 safety factor reduces to 3:1 when installed to 15° off axis

SPECIFICATION

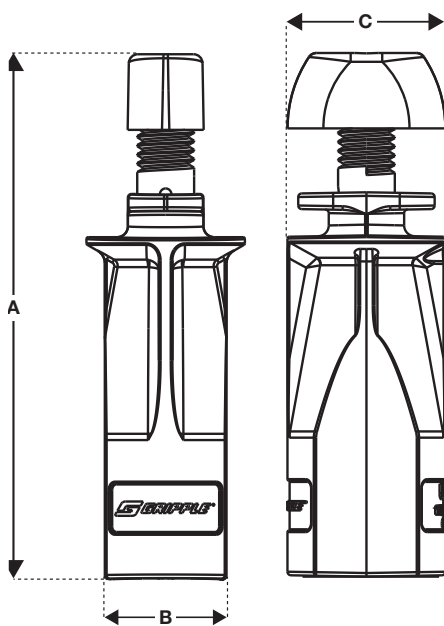

No. 2	Dimension	A	B	C
	mm	55	17	20

No. 3	Dimension	A	B	C
	mm	73	17	22

No. 4	Dimension	A	B	C
	mm	115 *	22	30

*Includes 25 mm M12 thread

AVAILABLE END FIXINGS

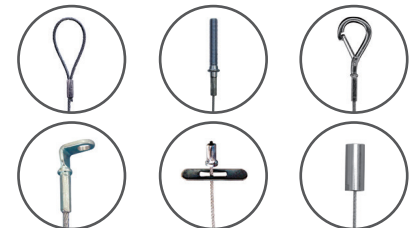

For more options on available end fixings please contact us or visit www.gripple.com

SUBMITTAL INFORMATION

Load Rating:

- No. 2 - 55 kg @ 5:1
- No. 3 - 110 kg @ 5:1
- No. 4 - 250 kg @ 5:1

Material:

- Housing** - Type ZA2 Zinc
- Carriage** - Acetal Copolymer
- Wedge** - Sintered steel hardened to min. 56 Rockwell C
- Button** - Acetal Copolymer