

DATA SHEET



W300-767112 1Ø – Westaflex 300mm Centrifugal Tube Fan

300mm Inline Centrifugal Tube Fan

- 300mm (12") inlet/outlet size
- EBM R2E280 motor
- Longer Duct Spigots
- Supplied with 1-meter lead and plug
- Maintenance-free and reliable



SPECIFICATIONS

○ Code 767112 2 Pole	
○ Motor: 230-420 V / 50HZ / 1Ø 0.264 Amp 2412 RPM	
○ Supplied with 1-meter lead and plug fitted	
○ Total Motor Wattage: 225 Watts	
○ Sound Pressure Level at 3m in dBA: 53	
○ Manufactured from ABS polymers case	
○ Free Air Fan Performance: 498 l/sec	
○ The motor is impedance protected.	
○ Impellor Diameter: 300mm diameter	
○ Temperature Range: -40°C to 70°C	

Features	Benefits
○ Controllable on a Variable Speed Drive	○ Enabling control down to 20% of full speed.
○ Easy to install with 75mm spigots	○ Saves time and money
○ IP44 Rated	○ Suitable wet room applications
○ The fan may be run at any angle	○ Allows the fan to be placed to suit your configuration
○ Accessories Available	○ Fans can be fitted with backdraft shutters, grilles & duct
○ 1 Year Warranty	

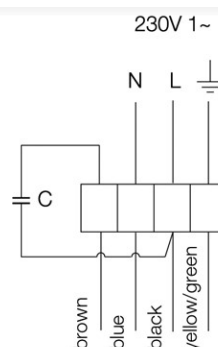

DATA SHEET

DIMENSIONS & ELECTRICAL DATA

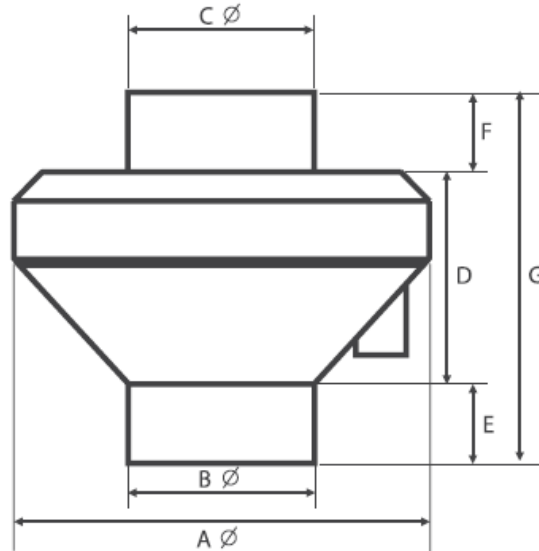

Product Code	Dia	A	B	C	D	E	F	G
767112	300	390	300	300	180	75	75	330

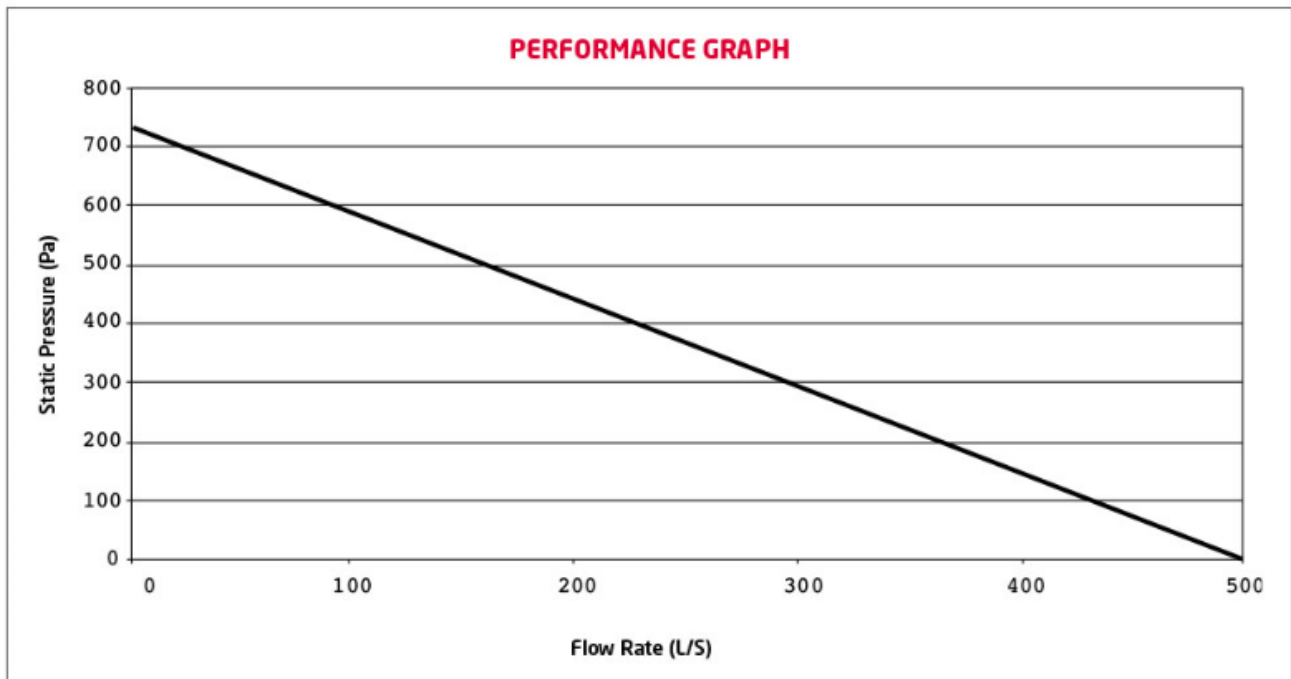

Product Code	Speed	Motor Rating (w)	220-240V / 50Hz / 1Ø		Sound Pressure Levels
			Full Load Current (A)	Speed Controller	
764106	2412	225		VA500	42

Sound pressure levels quoted are average dBA at 3m distance over a sphere, under free field conditions and are presented for comparative purposes only.